

## AboGen S3™ Collection Device

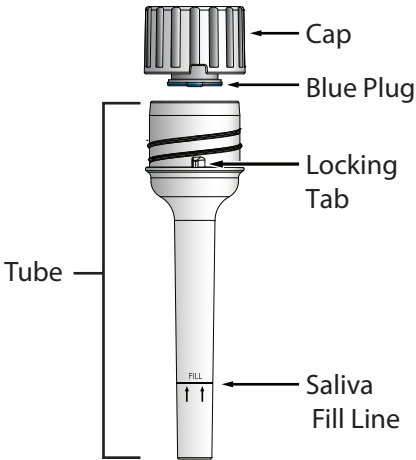

### Summary and Explanation of kit:

The AboGen S3™ is a saliva self-collection kit that provides the materials and instructions for collecting and stabilizing saliva specimens.

### Read all instructions prior to use.

For a detailed instructional video please visit [www.abogen.com](http://www.abogen.com)

**Contents:** Kit contains preservation fluid.

### Warning and precautions:

Wash with water if preservation liquid comes into contact with eyes or skin. Do not ingest. See MSDS at [www.abogen.com](http://www.abogen.com)

**Storage:** 15° C | 30° C  
59° F | 86° F

1

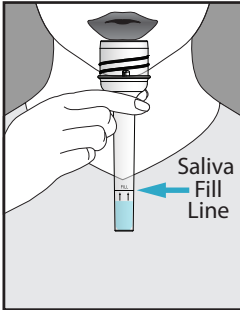

### USER INSTRUCTIONS

**Do NOT eat, drink, smoke, chew gum or brush teeth for 30 minutes before giving a saliva sample.**

- 1 Spit into the tube until the amount of liquid saliva (excluding bubbles) reaches the Saliva Fill Line.

*Most people take between 3 and 6 minutes to deliver a saliva sample.*

2

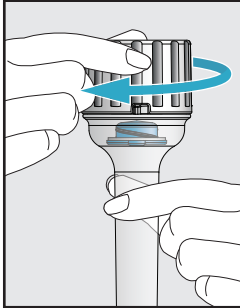

- 2 Place cap on the tube and screw on the cap.

Half way through the turning you will feel **resistance**, but keep turning, the Blue Plug will drop and the preservation solution will be released into the saliva.

Keep turning the cap until it locks in place.

3

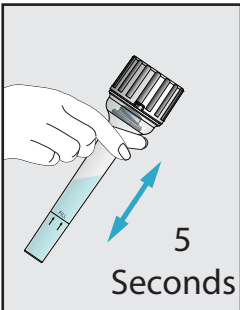

- 3 Make sure cap is locked. Gently shake the capped tube for 5 seconds to mix the preservation solution and the saliva.

### SHIPPING INSTRUCTIONS

Insert capped tube into the W U a e W T S Y S V e V f Z W T S Y Z

B S U M e V S W T S Y U a f S [ [ Y f Z W f g T W ] e Z [ b b ] Y T a j z The recyclable tray can be discarded.

B V W S V Z V e h W e f d b T W a d U a e [ Y f Z W T a j z

Place the shipping box in the mail, postage and tracking number are on the bottom of the box.

